

**Step 1:** Detach the ceiling rose canopy from the electrical wire. If your lights are an integrated LED, you will need to detach the electrical driver (round box with wires coming out). You will need to use these on the inside of the large white canopy system.

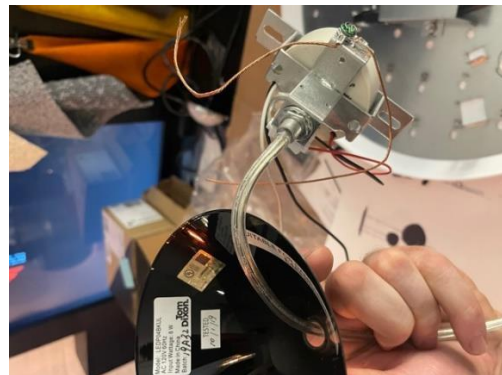

**Step 2:** Attach the white metal plate to your ceiling over your junction box bringing your J-box wiresthrough one of the holes to the underside of the white metal plate.

**2**

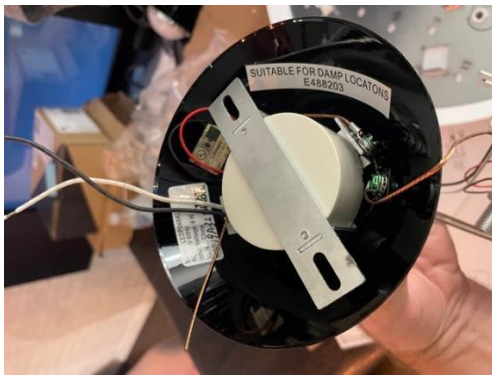
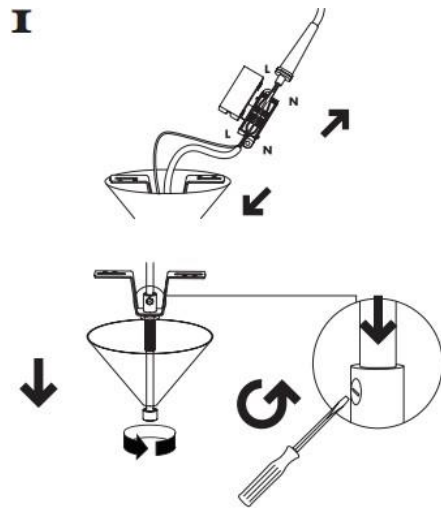
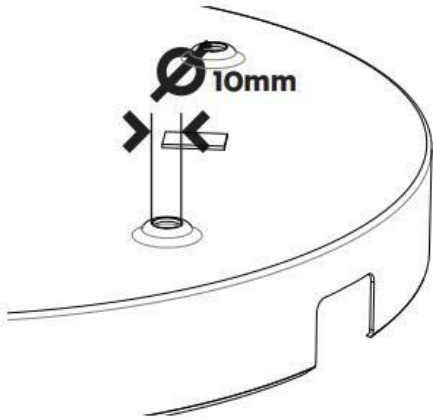
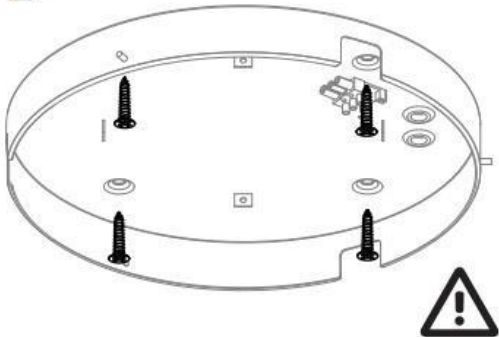

**3**

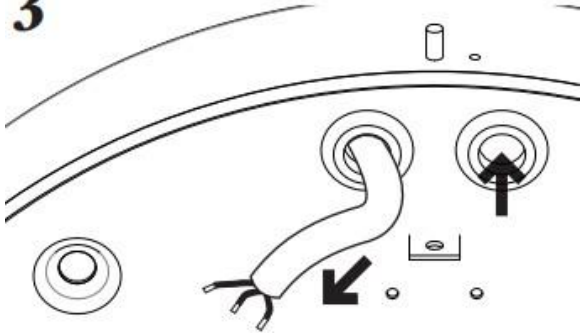

**Step 3:** For this portion, you will need to lay the silver metal plate inside of the white plastic plate. You will use the hole guide found in the imagery on the product webpage to identify which holes you need to drill. Mark the holes with a marker. Once you have marked the holes, you will use a 10mm drill bit to drill each of the holes into the white plastic cover.

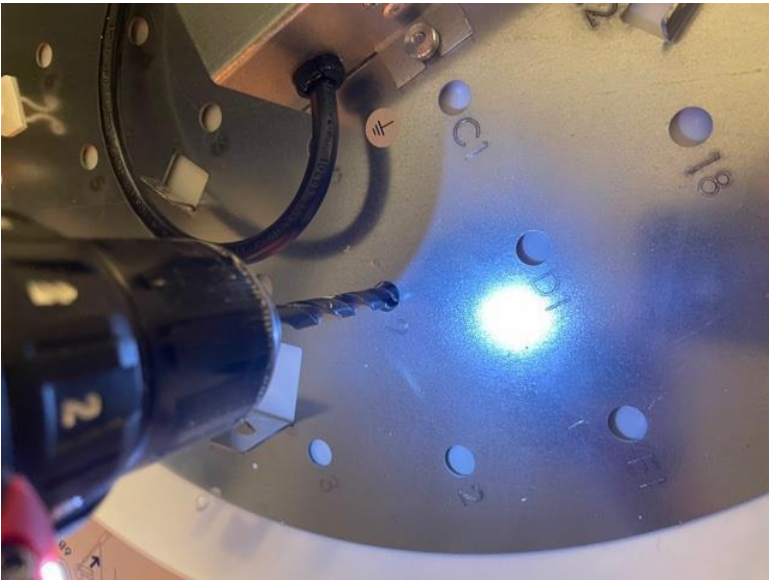
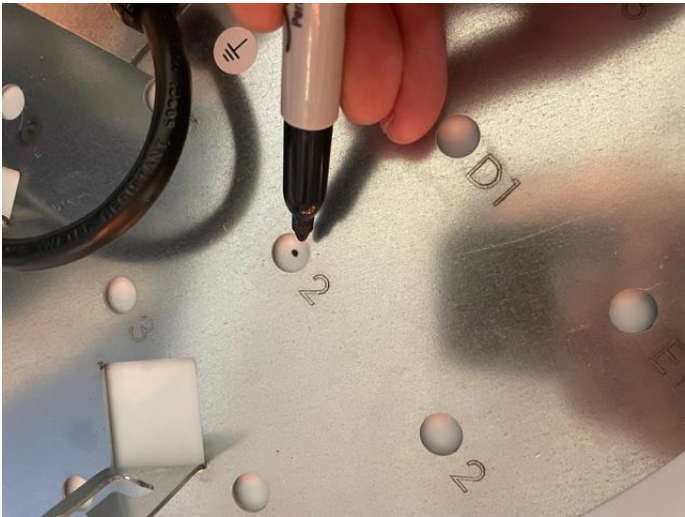
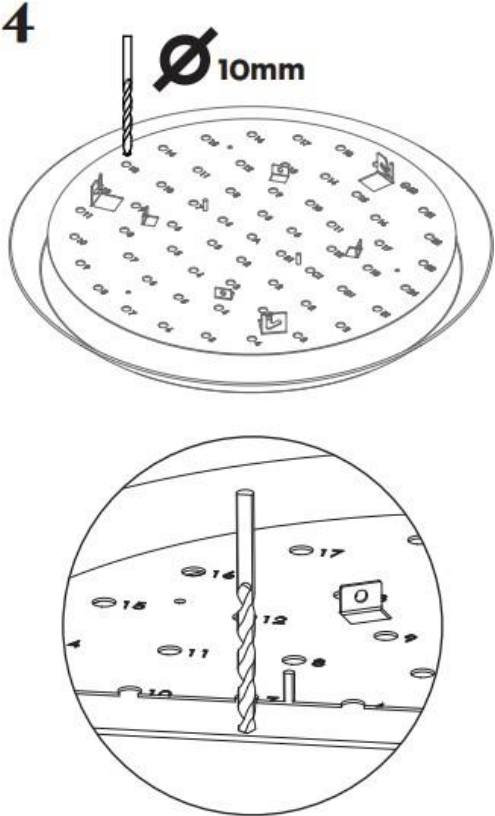

**Step 4:** You will slide the cord grips through the drilled holes (you may have to twist them in as it will be a tight fit). Please note you can use the metallic Cord grip that comes attached to the pendant electrical fitting in conjunction with the black cord grip that comes with the pendant system.

**5**

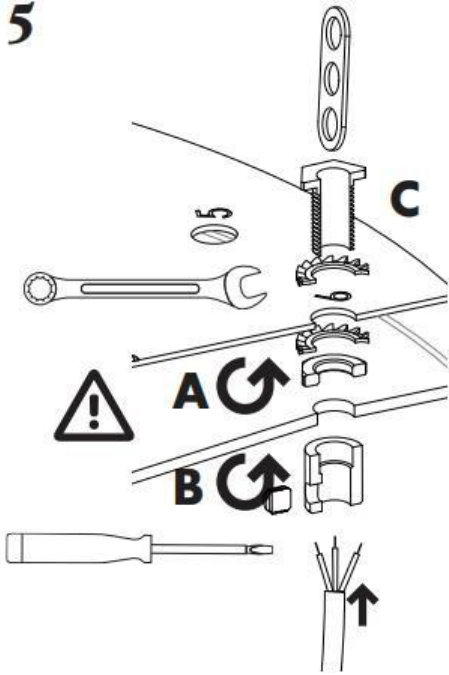

**Step 5:** Slide the wires from the electrical fitting through each of the cord grips at the desired drop length for each pendant. DO NOT cut the wires to length. You can gather excess wiring inside of the pendant system canopy in case you want to make changes in the future

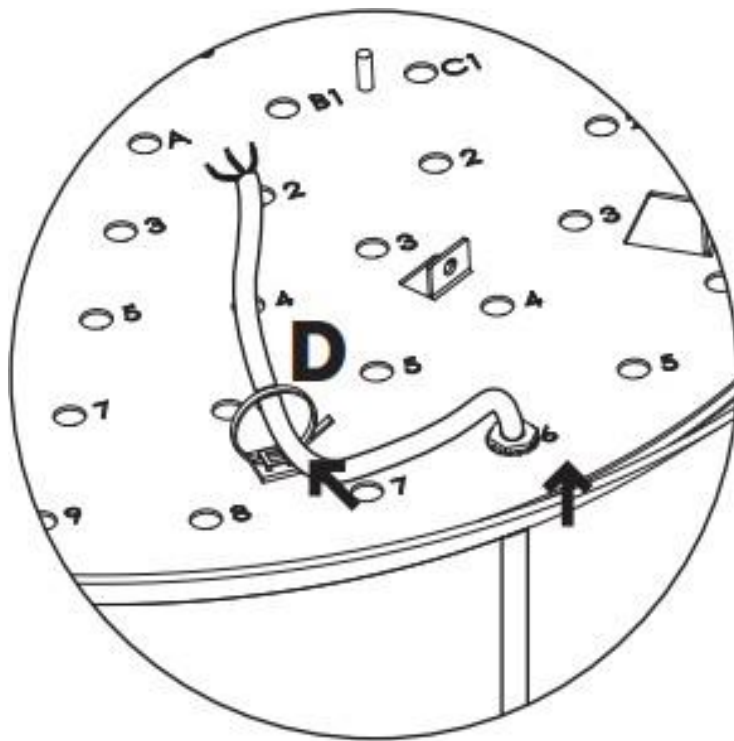

**Step 6:** If you have an integrated LED fixture, you will now attach the electrical driver that you removed from the ceiling rose in step 1. The thin red and white wires will connect directly to the pendant using the white wire clips that are included with the driver.

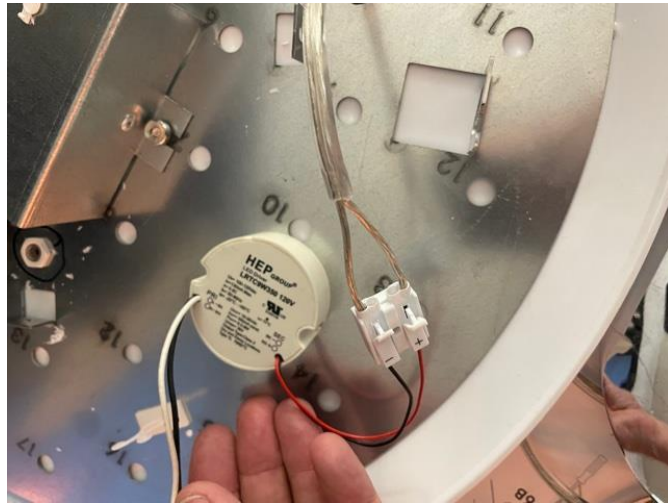

**Step 7:** The black and white wires will now be attached to the terminal block attached to the center of the pendant system. The black wire connects to L and the white wire connects to N.

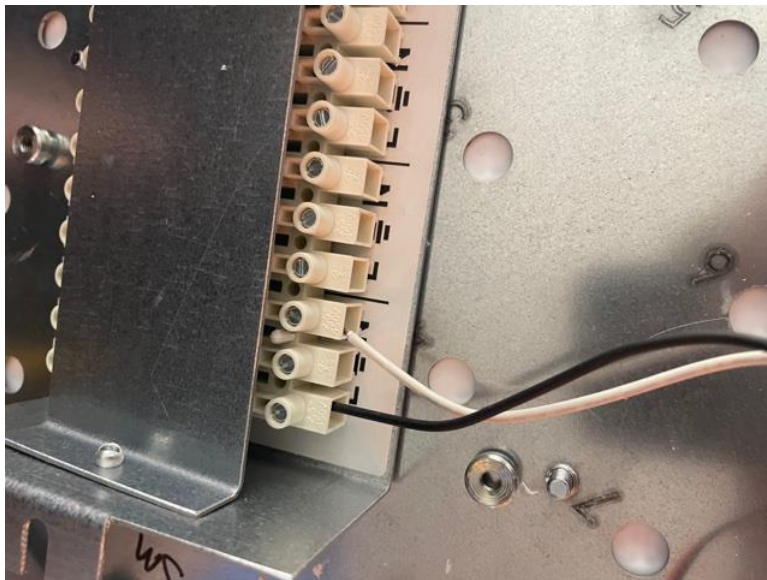

**Step 8:** Next you will connect the white plastic & silver metal plate to the white metal plate on the ceiling. Use the wire clips to suspend it prior to attaching your junction box wires to the terminal block. Keep excess wires inside of the canopy in the event you need to further adjust the lengths.

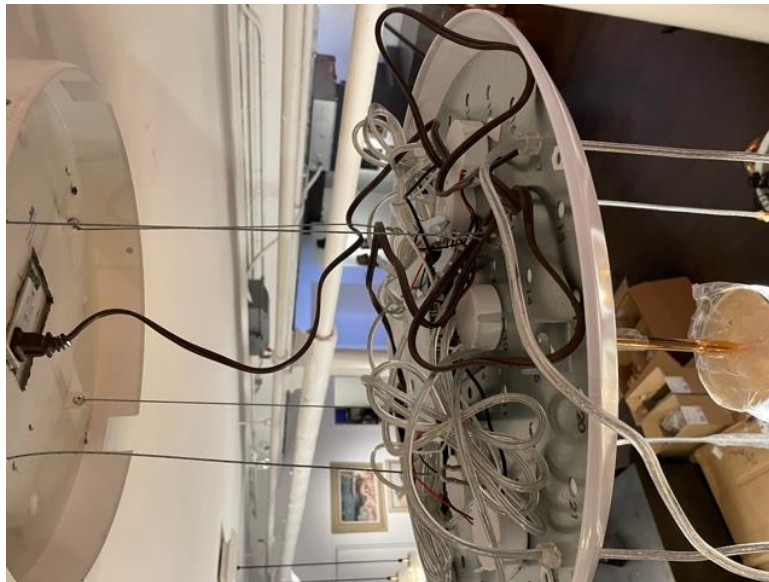
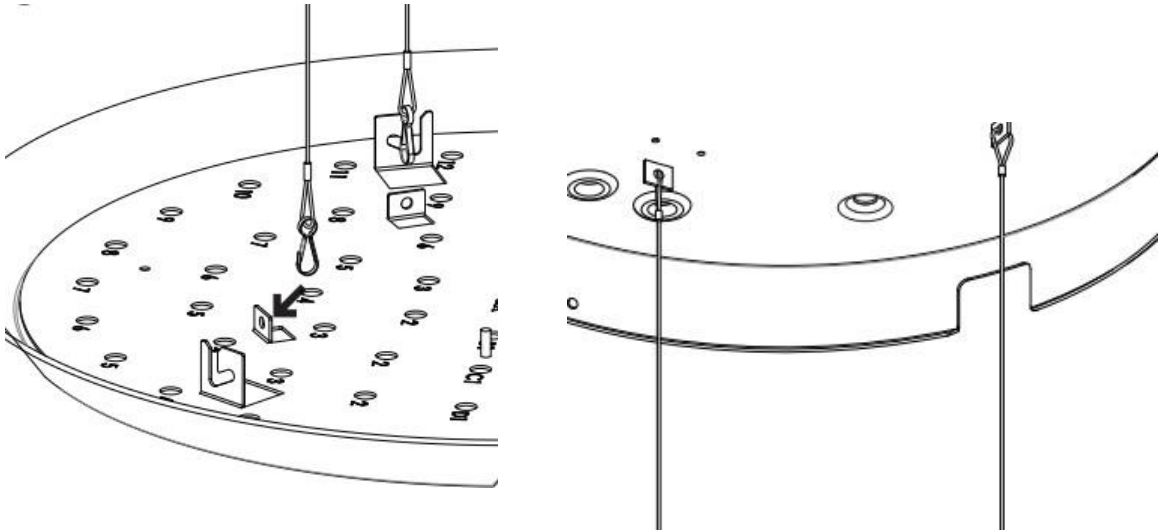

**Step 9:** Once your wires are connected and you have adjusted your cord drop lengths, you will raise the white plate and lock into place.

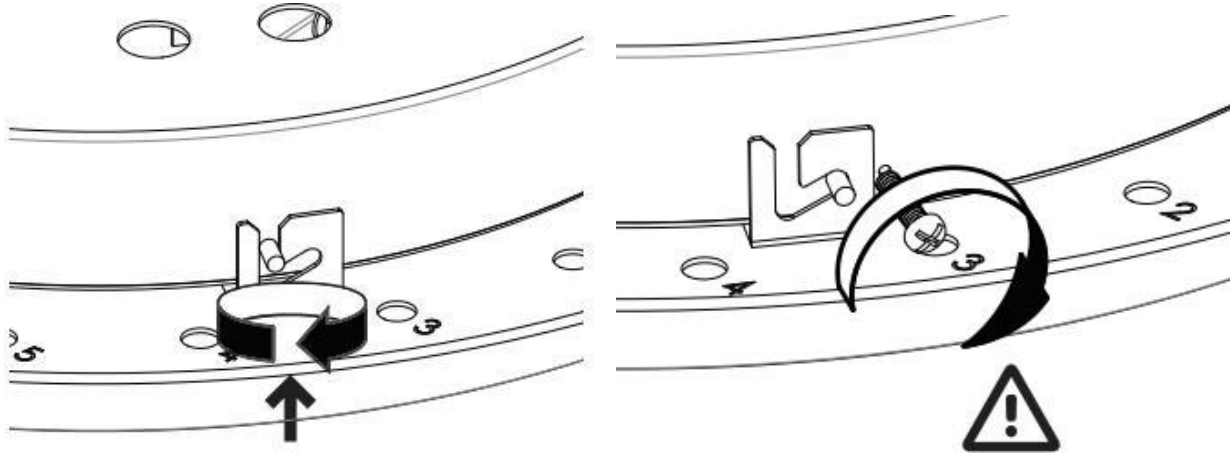

**Step 10:** Turn the lights on and send us pictures!!

